



MAGDALEN COLLEGE SCHOOL

INDEPENDENT DAY SCHOOL FOR BOYS 7 - 18 AND SIXTH FORM GIRLS



ADMISSIONS INFORMATION 2017-18



MAGDALEN COLLEGE SCHOOL

FOUNDED BY WILLIAM OF WAYNFLETE, 1480

CONTENTS

Applying to Magdalen College School
Introduction
Visiting and Registration Entry
Procedures (ages 7 to 13) Entry
Procedures (Sixth Form)
Scholarships, Awards and Bursary Provision
Admissions Dates
Results and Destinations
School Site Map
Travel to MCS
School Bus Routes
Policies and Additional Information
Fees
Contact Information and Web Links

www.mcsoxford.org

APPLYING TO MAGDALEN COLLEGE SCHOOL, OXFORD

ENTRY PROCEDURES (AGES 7 TO 13)

INTRODUCTION

Founded in 1480 by William of Waynflete, Magdalen College School is a day school, educating boys from the ages of 7 to 18 and girls in the Sixth Form. Pupils are normally admitted to the Senior School at age 11, 13 and 16 and to the Junior School at 7 (with some joining in subsequent years, dependent on the availability of places). It may sometimes be possible to admit pupils into other years: all enquiries should be made to the Registrar.

MCS is committed to admissions procedures which are fair, transparent, and designed to reward potential not merely attainment. In assessing all applicants to the school, we look for potential, not simply current attainment. We take a keen interest in the school reference, the wider interests of the pupil, and any other applicable information. The MCS papers and interviews are designed to explore the way in which each candidate thinks, helping us to assess overall promise. No special preparation is expected or required for the tests. We aim to make our admissions process enjoyable for both the candidates and their parents.

VISITING AND REGISTRATION

The best way to find out about MCS is to visit us. We offer an Open Morning in September and there are many opportunities to visit the school throughout the year to see our facilities, meet staff and current pupils and ask questions. Further information about our Afternoons with the Master, booking forms, and a list of admissions dates are available on the school website.

Individual appointments are available with the Registrar to discuss admissions issues.

MCS does not give priority to candidates who are registered early. The deadline for registrations is the end of October in the year preceding entry for all candidates, except those applying to join MCS at age 13 from preparatory schools via Common Entrance or the Scholarship route. In their case registration should be by the end of October when the candidate is in Year 6, to allow for the Common Entrance pre-test which is taken in January of that year at the same time as the 11+ tests. A registration form can be downloaded from the school website or obtained from the Registrar.

Before the Tests

In November we email all those who have registered for entrance tests, formally inviting candidates to attend. This email contains a reply slip for parents or guardians to complete and return. We will also request a school reference from the Headteacher of the candidate's current school. A second email providing details of the day itself, including the timings of the different tests, will be sent in December.

Junior School, 11+ and 13+ candidates sit the appropriate entrance examination between January and March preceding entry in September (see Admissions Dates, page 7, for details). Common Entrance candidates sit our Pre-test in January in Year 6 for entry in Year 9 and sit the same papers as the 11+ pupils. Sample papers for all entry stages can be found on the school website.

After the Tests

Most candidates are invited back for interview. We ask each boy to bring an item that he would like to talk about – for example a souvenir, picture or object of particular interest or importance to him. This is to help stimulate discussion.

At 7+ boys come for observation lessons, held about a week after the 7+ test day. These are in small groups. In the course of this lesson, each boy will leave the group to meet the Head of Junior School for a short informal interview. From 8+ to 13+, boys also do a short piece of reading for an oral comprehension as part of the interview process.

Tests for Entry to the Junior School

At 7+ boys take tests in English and Mathematics. From 8+ boys take tests in English, Mathematics and Verbal Reasoning. These are followed about a week later by interviews, as outlined above.

Tests for Entry at 11+

At 11+ boys take tests in English composition (fiction and non-fiction essays), Mathematics and Verbal Reasoning. They also have the opportunity to take part in an activity on the test day, as well as having lunch and breaks with snacks.

Tests for Entry at 13+

There are two methods of entry to the school at 13+: the Common Entrance Examination for boys at preparatory schools; and the 13+ Entrance Examination for candidates from maintained schools and independent schools where pupils are not prepared for Common Entrance.

Common Entrance papers are taken in the June preceding entry in September. Candidates are expected to perform to a suitable standard – for MCS this generally means in the region of 70%. Prior to this, candidates take the Pre-test in conjunction with those taking the 11+ in the January of Year 6, and sit the same English, Mathematics and Verbal Reasoning tests. Following the Pre-test, candidates are offered provisional places, subject to their performance at Common Entrance or Scholarship level.

The 13+ Entrance Examination takes place in March prior to September entry. Candidates take papers in English, Mathematics, Verbal Reasoning and either French or another modern foreign language.

ENTRY PROCEDURES (SIXTH FORM)

Registration and Testing

Individual appointments are available with the Registrar to discuss Sixth Form admission issues. The appointments start in September, and take place in the school day. Preference will be given to those who have already registered with the school.

Sixth Form registration forms are available through the Registrar's office or on the school website and must be submitted by 31st October. Applicants are able to apply for a bursary at this stage (see below).

Candidates will be invited to the A-Level Options night in November where they will have the chance to meet Heads of Departments and discuss A-Level choices.

Interviews start in November. There will be at least a week's notice of the interview date. These will take place from 5.00pm and will last two hours. References from a candidate's current school will be sought ahead of the interview.

The general interview will focus on academic interests, GCSE predictions, A-level choices, Waynflete Studies, extra-curricular interests and any questions the candidate may want to ask. There will be another two specialist interviews with senior members of staff, whose identity

will depend on the candidate's likely focus in the Sixth Form – science or arts.

Candidates will also sit a 45-minute Verbal Reasoning test while they are at the school as this helps to give MCS a standardised reference point for every pupil. We do not ask applicants to do any form of exam save in exceptional cases.

Sixth Form applicants whose first language is not English are required to have obtained IELTS Level 7. Please contact the Registrar to discuss this.

Offers will be made from 1st December. These will be principled and positive: we do not intend to make offers that we think applicants cannot obtain, and we will only give offers to those who we are confident will thrive here. Candidates will be expected to achieve around 6A*s or equivalent at GCSE and, in particular, A*s in those subjects they wish to take at A-level.

Bursary awards will be considered once a formal offer has been made.

Acceptance

In March, there will be a Quiz Night for all pupils entering the Sixth Form. Candidates will meet Sixth Form teachers, Heads of Department, current Sixth and Fifth Formers and will begin to finalise A-Level choices.

Please feel free to contact the Registrar at any stage of the admissions and applications process (registrar@mcsoxford.org).



SCHOLARSHIPS, AWARDS AND BURSARY PROVISION

INTRODUCTION

Magdalen College School is historically committed to offering places to those most able to benefit from an MCS education, irrespective of financial means, and to rewarding excellence.

The school is proud of the Scholarship and Bursary provision which it has been able to establish over many years. This owes much to the assistance of many benefactors and friends of the school, whose generosity is annually acknowledged at the Commemoration Service in the University Church. The school, in common with many other leading independent schools, assigns a percentage of its annual income to its Scholarship and Bursary scheme, thus benefiting a significant number of children each year. We seek to make our scheme as broad, flexible and imaginative as possible, whilst also conforming to national guidelines.

These pages contain a summary of the financial assistance and awards available at each relevant level of entry (11+, 13+ and 16+) along with details on how to apply.

SCHOLARSHIPS

Scholarships and Exhibitions are awarded on entry to the school, or internally, in recognition of a pupil's merit and potential.

Music, Art and Sport Scholarships are available at 13+ and 16+. Drama is also available at 16+.

All-Rounder Awards are made to a number of pupils of high academic ability who are likely also to make a substantial contribution to the wider life of the school.

Governors' Presentation Awards are made to a pupil on entering the school as a recognition of talent and potential which might develop into the eventual award of a Scholarship or Exhibition.

Honorary Scholarships and Exhibitions do not carry any less esteem within the school, or to wider communities such as universities, but they do not have a financial value. These are awarded to existing pupils at 13+ and 16+.

In order to maximise financial efficiency and educational benefit, no pupil may hold more than one Scholarship or Exhibition bringing with it financial recompense: the second and any subsequent award will always be Honorary. In certain circumstances, Honorary Awards may be made to those who are already members of the school who have progressed in the school to such a standard that their achievements merit wider recognition.



HOW AWARDS ARE MADE

All awards for each year group are made in the year preceding entry. Awards are made by the Master, as soon as possible after decisions about entry to the school are made and/or exam results are known. In addition, the Master chairs an annual meeting of senior members of staff in the Trinity term, which scrutinises all aspects of the school's scholarship and bursary provision, and makes awards to internal candidates.

11+ Awards

Scholarships, Exhibitions, All-Rounder Awards and Governors' Presentation Awards are all available. All awards are equally open to external candidates and members of the MCS Junior School and no application is necessary.

13+ Awards

Academic Scholarships for those educated at preparatory schools are by competitive examination, taking place in the Hilary term. Application forms are available from the Registrar or can be downloaded from the school website and must be returned **by Friday 12th January 2018**. Academic Scholarships for applicants from schools in the maintained sector are awarded on the basis of the school's own 13+ entrance examination which takes place in February each year.

No application is necessary. All-Rounder Awards and Governors' Presentation Awards are also made each year, on the basis of performance in the Common Entrance Pre-test or 13+ entrance examination.

Scholarships in Art, Music and Sport become available at 13+ to external and internal applicants. Application forms are available from the Registrar or can be downloaded from the school website and must be returned to the Registrar **by Friday 12th January 2018**.

In Art, all candidates submit a portfolio, and shortlisted pupils attend a scholarship interview. In Music, all candidates are auditioned and should not be of less than Grade VI standard in at least one instrument. In Sport, applicants should be of County standard in at least one sport, and are invited to the school for an assessment day.

16+ Awards

Academic Scholarships are awarded on the basis of the school's standard admissions procedure for Sixth Form applicants. They are conditional on GCSE performance and are awarded at the start of the Michaelmas term.



All-Rounder and Governors' Presentation Awards and Art, Music and Sport Awards operate exactly as outlined above, save that in Music, awards are sub-divided into Choral, Instrumental and Organ Scholarships. (For Instrumental and Organ awards, candidates should generally be of a standard approaching or exceeding Grade VIII.) Drama Awards are also offered at 16+.

Further details and application forms are available from the Registrar or can be downloaded from the school website and must be returned to the Registrar **by Monday 6th November 2017 for Art, Drama and Sport, and by Friday 12th January 2018 for Music**.

At 13+ and 16+ all internal pupils are assessed for Honorary Academic Scholarships without any need for application. Further details are available from the Registrar and on the school website.

FINANCIAL ASSISTANCE (BURSARIES)

School Governors' Bursaries are awarded to new pupils whose parents or guardians are of limited financial means. They are based on a declaration of income and assets and are subject to annual financial assessment. They must also apply for a School Governors' Bursary when they confirm that their son or daughter is to sit the entrance examination: bursaries are then awarded when a place at the school is offered. Where demand exceeds funds, available awards will be made on the basis of the applicant's performance in the entrance examination. As a rule, bursary funding is not available to boys outside the senior school. Further details are available from the Bursar and on the school website.

Hardship Bursaries are awarded to existing pupils where a change in parents' or guardians' circumstances has resulted in difficulty in meeting tuition fees and may result in the child being withdrawn part-way through a stage of education. They are based on a declaration of income and assets and are subject to financial assessment. They are awarded for a short period only and priority will be given to those pupils who are either in their GCSE or A-Level years.

If having read the bursary information document you wish to apply for a bursary, you can complete a Means Testing Form in support of an application, which is available to download on the website or from the Bursar (contact details overleaf).

LEVEL OF AWARDS AND FINANCIAL ASSISTANCE

Scholarships are worth £300 per annum. In addition, Music Scholars will receive free tuition for one instrument from a teacher employed by the school.

Exhibitions are worth £200 per annum. All-Rounder Awards are worth £300 per annum. A Governors' Presentation Award offers a reduction of £500 in the first year of fees.

There is no financial assessment when allocating any of the aforementioned awards.

Bursary awards of up to 100% discount on the tuition fees are available but are subject to testing of parental means. For more details of the bursary schemes, please see the school website.

FURTHER INFORMATION AND ENQUIRIES

All enquiries relating to Scholarships and other awards are handled by the Registrar. Further information, application forms and sample papers are all available in the Admissions section of the school website (see below).

All enquiries relating to Financial Awards are handled by the Bursar. There are also national and local charities who offer financial assistance, and further information is available on these from the Bursar.



EMAIL CONTACTS AND WEB LINKS

Registrar, Mrs Barberine Mallett:
registrar@mcsoxford.org

Bursar, Mr Tim Knowles: bursar@mcsoxford.org

General information for prospective parents can be found here: www.mcsoxford.org/admissions

Information on Bursaries, including a Means Testing Form can be found here:
www.mcsoxford.org/scholarships

Further information about Scholarships, including sample papers and application forms can be found here:
www.mcsoxford.org/scholarships/applying-for-awards

ADMISSIONS DATES 2017–2018

MICHAELMAS TERM 2017

Saturday 16th September	Open Morning and Chorister Voice Trials 9.30 am - 12 noon
Thursday 28th September	An Afternoon with the Master - Sixth Form 2.30 – 4.30 pm
Friday 6th October	Years 5 and 6 Prep Schools' Quiz 4.45 pm – 6.45 pm
Tuesday 10th October	Primary Schools' Maths Challenge 12 noon – 2.30 pm
Thursday 12th October	An Afternoon with the Master – Senior School 2.30 - 4.30 pm
Tuesday 31st October	Deadline for registrations for 2018 entry and Pre-test for 2020 entry
Wednesday 1st November	Sixth Form interviews begin - November and December from 4.45 pm
Thursday 2nd November	An Afternoon with the Master and Head of Junior School 2.00 - 3.20 pm
Monday 6th November	Application deadline for 16+ Art, Drama and Sport Scholarships
Monday 13th November	16+ candidates: A-Level Options Evening 6.30 – 9.00 pm
Friday 1st December	16+ Art Scholarship portfolios to be submitted by 8.30 am
Thursday 7th December	An Afternoon with the Master and Head of Junior School 2.00 - 3.20 pm
Thursday 7th December	16+ Art and Drama Scholarship Assessments from 4.00 pm
Friday 8th December	16+ Sports Scholarship Assessments 4.30 - 6.30 pm

HILARY TERM 2018

Friday 12th January	Application deadline for Academic, 13+ Art and Sport and all Music Scholarships
Wednesday 17th January	8+/9+/10+ Entrance Tests 9.00 am - 2.00 pm
Saturday 20th January	11+ Entrance Examinations and Pre-test for 2020 entry 9.00 am - 2.30 pm
Tuesday 23rd January and Wednesday 24th January	8+/9+/10+ Interviews
Saturday 27th January	7+ Entrance Tests 9.00 am - 2.00 pm
Monday 29th January	13+ Music Scholarship Auditions from 9.00 am
Tuesday 30th January	Pre-test Interviews and 11+ Interviews
Wednesday 31st January	11+ Interviews
Wednesday 31st January	16+ Music Scholarship Auditions from 4.00 pm
Thursday 1st February and Friday 2nd February	7+ Observation Lessons 9.00 - 11.00 am and 1.00 - 3.00 pm
Monday 26th February and Tuesday 27th February	13+ Academic Scholarship Examinations
Friday 2nd March	13+ Entrance Examinations 9.00 am - 3.00 pm
Friday 9th March	13+ Art Scholarship portfolios to be submitted by 8.30 am
Friday 9th March	13+ Interviews
Friday 9th March	Lower Sixth Induction Quiz Night 5.30 – 7.30 pm
Thursday 15th March	An Afternoon with the Master and Head of Junior School 2.00 - 3.20 pm
Friday 16th March	13+ Sports Scholarship Assessments 9.00 am - 3.30 pm
Friday 16th March	13+ Art Scholarship Interviews from 4.00 pm
Thursday 22nd March	An Afternoon with the Master – Senior School 2.30 - 4.30 pm

TRINITY TERM 2018

Tuesday 5th to Friday 8th June	Common Entrance
Friday 15th June	Lower Sixth Induction 4.00 - 6.00 pm
Saturday 16th June	Second Form and Lower Fourth Induction Morning 9.30 - 11.30 am
Saturday 16th June	Junior School Induction Morning 9.30 - 11.30 am
Tuesday 19th June	An Afternoon with the Master and Head of Junior School 2.00 - 3.20 pm
Thursday 21st June	An Afternoon with the Master - Senior School 2.30 - 4.30 pm

RESULTS AND DESTINATIONS 2017

A2 RESULTS 2017

Year	No of candidates	No of exam entries	% A*	%A*-A	%A*-B	% A*-C	National Average % A*-C
2017	147	506	41	82	97	100	77
2016	175	609	50	89	99	100	77
2015	135	462	44	83	97	100	77
2014	143	490	44	87	97	100	77
2013	129	456	46	92	100	100	77
2012	130	465	37	86	97	100	77

Year	4 or more A*	3 or more A*
2017	11	29
2016	26	53
2015	12	26
2014	18	33
2013	18	35



Subject	Total Taken	A*	A	B	C
Art	13	6	4	3	0
Biology	59	24	24	8	3
Chemistry	73	16	33	21	3
Chinese	2	0	2	0	0
Dutch	1	1	0	0	0
Economics	29	11	14	4	0
English	35	24	8	3	0
French	11	5	5	1	0
Geography	27	8	12	5	2
German	4	1	3	0	0
Greek	3	2	1	0	0
History	24	5	14	4	1
Latin	10	3	6	1	0
Maths	98	55	32	10	1
Further Maths	28	17	5	4	2
Music	4	1	2	1	0
Philosophy	2	0	2	0	0
Physics	37	16	16	4	1
Politics	12	3	8	1	0
Religious Studies	22	10	10	2	0
Spanish	10	0	5	5	0

GCSE RESULTS 2017

Year	No of candidates	No of exam entries	% A*	%A*-A	%A*-B	% A*-C	National Average % A*-B
2017	99	992	84	97	99.5	100	43
2016	99	990	74	95	99	100	43
2015	96	964	71	93	99	100	43
2014	117	1178	73	93	99	100	43
2013	92	925	74	95	99	100	43
2012	105	1057	67	94	100	100	44

Year	10 or more A*	9 or more A*
2017	35	66
2016	17	36
2015	20	35
2014	35	51
2013	24	42



Subject	Total Taken	A*	A	B	C	D
Art	15	9	4	0	2	0
Biology	99	93	5	1	0	0
Chemistry	99	92	4	3	0	0
Chinese	1	1	0	0	0	0
English Language	99	69	22	8	0	0
English Literature	99	71	16	11	1	0
French	86	73	12	1	0	0
Geography	60	47	12	0	1	0
German	15	12	2	1	0	0
Greek	12	12	0	0	0	0
History	67	56	10	1	0	0
Latin	35	35	0	0	0	0
Maths	99	93	5	1	0	0
Music	12	11	1	0	0	0
Physics	99	92	6	0	1	0
Religious Studies	65	41	23	1	0	0
Spanish	29	29	0	0	0	0

DESTINATIONS OF LEAVERS 2017

University	Subject	University	Subject		
Bath	Architecture	Cardiff	Biomedical Sciences		
	Biochemistry		Law		
	Chemical Engineering		Medicine		
	Chemistry		Charles University, Prague	Business Studies	
	Computer Science			Anthropology	
	Natural Sciences			Biomedical Science	
	Social Sciences			Classics	
	Birmingham			Human Neuroscience	Economics with Business
				Medicine	Economics with Management
				Medicine	Geography
Physics		History			
Bournemouth		Art Foundation		Law	
		Bristol		Aerospace Engineering	Law
			Biochemistry	Law	
			Biochemistry	Mathematics	
			Biochemistry	Physics	
			Biology	Politics	
	Biomedical Sciences		Theology		
	Chemistry		Theology & Religion		
	Chemistry		Arabic		
	Economics		Arabic & Persian		
Economics & Finance	History				
Environmental Geoscience	Philosophy & English				
Film & Television	Theology				
Geography	Theology & Religion				
Geography	Edinburgh	Animal Behaviour			
History of Art	Exeter	English			
Mathematics & Computer Science	Exeter	Management			
Mechanical Engineering		Mechanical Engineering			
Medicine		Physics			
Medicine		Psychology			
Physics		Psychology			
Spanish		Theology & Religion			
Zoology		Theology & Religion			
Brighton & Sussex Medical School		Medicine	Guildhall	Music	
		Medicine	Imperial	Chemical Engineering	
		Medicine	Imperial	Chemistry	
	Medicine	Medicine			
Cambridge	Arabic	KCL		Economics & Management	
	Classics	KCL		Medicine	
	Economics			Philosophy	
	English			Lancaster	Linguistics
	English			Leeds	Physics with Astrophysics
	English			LSE	Economics
	Geography			LSE	Economics
	History				Management
	History		Manchester		Chemical Engineering
	Mathematics		Manchester		Engineering
French & Russian	French & Linguistics				
Music	Politics & Modern History				
Natural Sciences	Newcastle	Architecture			
Natural Sciences	Newcastle	History			
Theology		Intl Management & Spanish			
		Medicine			

University
Oxford

Subject
Biological Sciences
Chemistry
Classics
Engineering
Engineering
English
English
Experimental Psychology
History
Law
Mechanical Engineering
Medicine
Philosophy & Theology
Physics
PPE
PPE
Theology & Religion

Oxford Brookes

Art Foundation
Art Foundation
Computer Science
Social Anthropology & Spanish
Marketing & Business Economics

Queen's, Belfast
Reading
Sheffield

Medicine
Psychology

Southampton

Chemistry
Law

St Andrews

Chemistry
English
Geography
Theology

St George's
Toronto

Medicine
Music

University
UCL

Subject
Arts & Sciences
Biochemistry
Economics
Economics
Economics
Engineering
English
European Social & Political Studies
Geography
Geography
Law
Medicine
Medicine
Medicine
Medicine
Physics

Warwick

Economics
Economics
English
Modern Languages & Economics

York

Biochemistry
English
Politics with International Relations
Social & Political Sciences





MAGDALEN COLLEGE SCHOOL

- Big School 11
- Christ Church Sports Field 4
- Christ Church Sports Pavilion 5
- Colin Sanders Building 19
- Dining Hall 1
- Junior School 13
- Magdalen Bridge 11
- Magdalen College 9
- Merton Field 8
- Milham Ford 20
- Music School 18
- New Building 1
- Quincentenary Building 17
- Reception 1
- School Field 7
- School Field Pavilion 6
- School House 15
- Science Building 16
- Sixth Form Centre 15
- Sports Hall 8
- Studio 2
- The Plain Roundabout 12
- The Spit 10
- 1928 Building 15

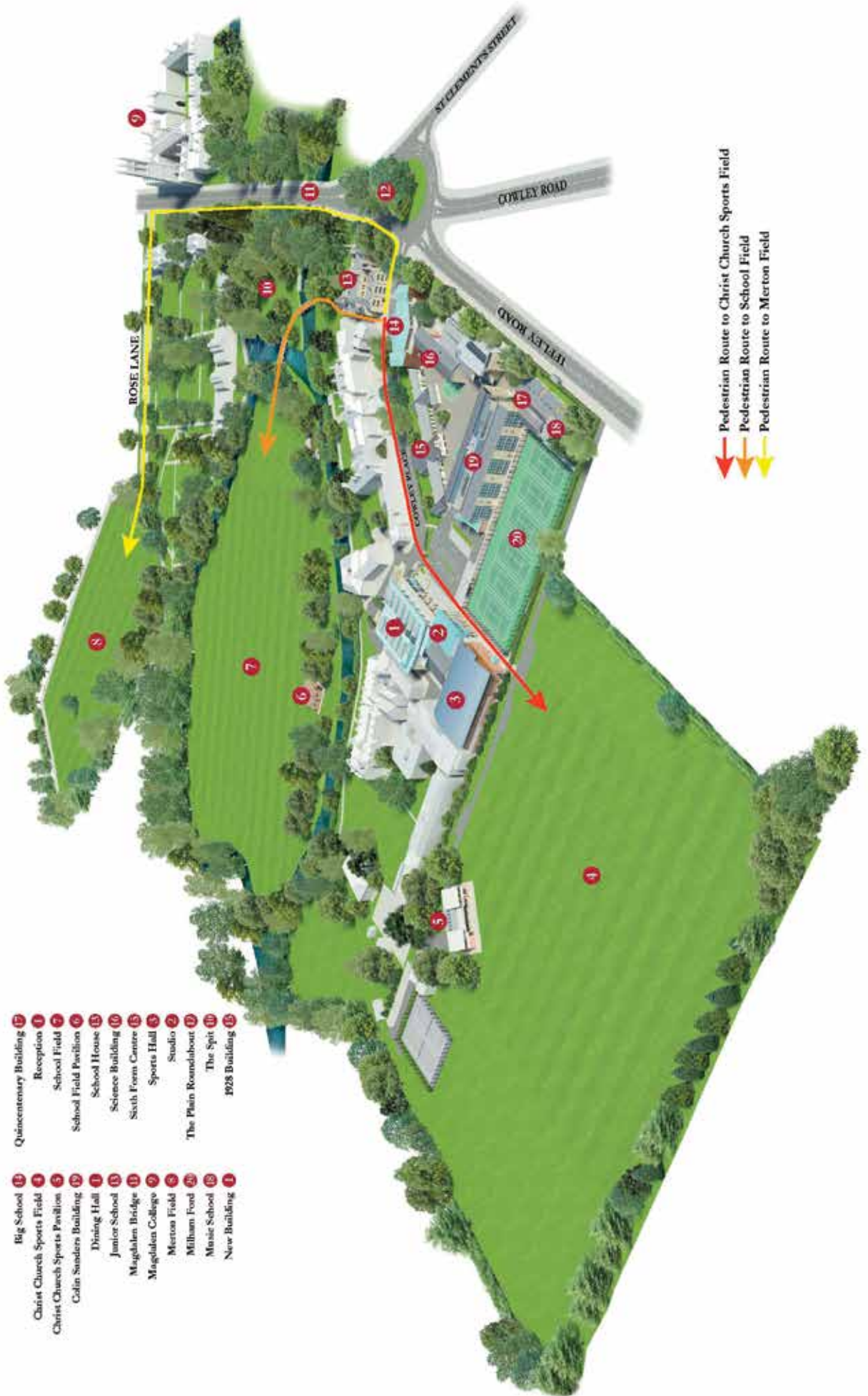

- Pedestrian Route to Christ Church Sports Field
- Pedestrian Route to School Field
- Pedestrian Route to Merton Field

TRAVEL TO MCS

TRAVEL BY SCHOOL BUS (OSBP)

MCS is a founder member of the Oxford Schools' Bus Partnership (OSBP), a joint collaboration between five Oxford schools, d'Overbroeck's, Headington School, MCS, Oxford High School and Rye St Antony School. It was formed to provide safe, efficient and reliable routes to school for pupils, while helping to ease congestion and reduce the schools' environmental footprint.

See the following pages for more details of routes, timetables and pricing. More info at www.osbp.net.

TRAVEL BY BUS

MCS enjoys a central position by the River Cherwell and close to bus stops for a number of public bus services. For information of routes, see the bus companies' websites.

Oxford Tube: www.oxfordtube.com

Oxford Bus Company: www.oxfordbus.co.uk

Stagecoach: www.stagecoachbus.com

DIRECTIONS BY CAR

MCS is located on Cowley Place, just off the Plain roundabout. This is accessed from the East (Headington) via St Clement's Street, from the South East via the Iffley and Cowley Roads, and from the West via Magdalen Bridge. The Senior School is located at the far end of Cowley Place on the left hand side (opposite the entrance to St Hilda's College). The Junior School is in School House, on the right as you turn into Cowley Place.

Traffic can be heavy at the beginning and end of the school day. SatNav users should use the postcode OX4 1DZ to locate us.

We regret that parking is not currently available on site due to major building work.



Oxford Schools Bus Partnership

Bus routes, September 2017



www.osbp.net

To book a seat, please email info@osbp.net

May 2017

Oxford Schools Bus Partnership

Timetable, September 2017

Route 1 - Middleton Cheney

STOP	DESCRIPTION	AM	PM	ZONE
Middleton Cheney	Outside Diamond House Main Road	0640	1759	4
Brackley	Market Place	0653	1749	4
A43/B4031	Layby opposite Barley Mow Farm	0657	1745	4
Croughton	The Blackbird	0702	1740	4
Aynho	On B4100 opp. school	0707	1735	4
Adderbury	Red Lion bus stop	0712	1730	4
Deddington	Market Square	0717	1725	3
A4260 North Aston Turn	Lay-by	0722	1720	3
Hopcroft's Holt	Before traffic lights	0727	1717	3
A4260 Bunker's Hill Turn	Adj. to Bunker's Hill Turn	0733	1714	3
Kidlington	Gosford School bus stop	0742	1705	2
Pupils can also board at the following stops (or interim stops if timings allow) for cross-city travel e.g. from Summertown to Headington schools:				
d'Overbroeck's (Sixth Form Centre)	Banbury Road (nr Squitchey Lane)	0755	1635	
Oxford High School (Senior School)	Charlbury Road	0800	1628	
Oxford High School (Junior School)	Bardwell Road	0805	1624	
d'Overbroeck's (Years 7-11)	Banbury Road nr Park Town	0809	1622	
Magdalen College School	The Plain roundabout, outside Sainsbury's (AM) / opposite Sainsbury's (PM)	0815	1612	
Headington School	Headington Road (AM) / Headley Way (PM)	0820	1605	
Rye St. Antony	Franklin Road	0825	1607	

Route 2 - Marsh Gibbon

STOP	DESCRIPTION	AM	PM	ZONE
Marsh Gibbon	Post Office	0645	1746	4
Bicester	Market Square	0700	1731	3
Wendlebury	Lion Public House	0710	1721	3
Weston-on-the-Green	Oddington Grange entrance (AM) The Chequers PH (PM)	0715	1718	3
Islip	By Dr South's School	0720	1711	2
Beckley	Opp. Abingdon Arms	0730	1701	1
Beckley	Village Hall	0732	1659	1
Pupils can also board at the following stops (or interim stops if timings allow) for cross-city travel e.g. from Summertown to Headington schools:				
Headington School	Headley Way (AM) Headington Road (PM)	0747	1640	
Rye St. Antony	Franklin Road	0750	1643	
Magdalen College School	The Plain roundabout, opp. Sainsbury's (AM) / outside Sainsbury's (PM)	0758	1635	
d'Overbroeck's (Years 7-11)	Banbury Road, nr Canterbury Rd (AM) / Woodstock Road nr Leckford Road (PM)	0808	1630	
Oxford High School (Junior School)	Bardwell Road	0810	1628	
Oxford High School (Senior School)	Charlbury Road	0815	1625	
d'Overbroeck's (Sixth Form Centre)	Banbury Road nr Squitchey Lane	0820	1620	

Route 3 - Haddenham

STOP	DESCRIPTION	AM	PM	ZONE
Haddenham	Railway station	0655	1743	4
Thame	Aylesbury Road, opp. cricket ground	0702	1738	4
Long Crendon	The Square (bus stop)	0709	1730	4
Shabbington	Bicester Road bus stop, before The Angel	0715	1725	4
Worminghall	Ickford Road crossroads, (bus stop Clifden Road)	0720	1720	3
Wheatley	Top of A40 slip road	0730	1710	1
London Road (just past Park & Ride)	Bus stop outside Nielsens	0735	1705	1
Pupils can also board at the following stops (or interim stops if timings allow) for cross-city travel e.g. from Summertown to Headington schools:				
Headington School	Headley Way (AM) Headington Road (PM)	0745	1640	
Rye St. Antony	Franklin Road	0750	1642	
Magdalen College School	The Plain roundabout, opp. Sainsbury's (AM) / outside Sainsbury's (PM)	0758	1635	
d'Overbroeck's (Years 7-11)	Banbury Road, nr Canterbury Rd	0808	1629	
Oxford High School (Junior School)	Bardwell Road	0808	1627	
Oxford High School (Senior School)	Charlbury Road	0818	1625	
d'Overbroeck's (Sixth Form Centre)	Banbury Road nr Squitchey Lane	0823	1620	

Route 4 - Reading

STOP	DESCRIPTION	AM	PM	ZONE
Reading	Departs bus depot	0630	-	5
Earley	Chatton Close bus stop (Asda)	0645	1810	5
Woodley	Headley Road bus stop	0655	1800	5
Henley	Hart Street bus stop	0710	1740	5
Lower Assendon	Layby on A423 before Stonor Turn	0713	1735	4
Bix	Bix bus stop	0715	1730	4
Nettlebed	The Old Kiln Roundabout	0720	1725	4
Lewknor	Before slip road onto M40 (London coach stops)	0738	1705	4
Pupils can also board at the following stops (or interim stops if timings allow) for cross-city travel e.g. from Summertown to Headington schools:				
Headington School	Headington Road / Headley Way	0755	1645	
Rye St. Antony	Franklin Road	0756	1646	
Magdalen College School	The Plain roundabout, opp. Sainsbury's (AM) / outside Sainsbury's (PM)	0803	1635	
d'Overbroeck's (Years 7-11)	Banbury Road nr Park Town	0821	1627	
Oxford High School (Junior School)	Bardwell Road	0822	1626	
Oxford High School (Senior School)	Charlbury Road	0825	1625	
d'Overbroeck's (Sixth Form Centre)	Banbury Road nr Squitchey Lane	0835	1620	

Route 5 - Cookley Green

STOP	DESCRIPTION	AM	PM	ZONE
Cookley Green	Opp. bus shelter	0655	1748	4
Watlington	Bus stop in Cuxham Road, by Sheldon Piece	0702	1741	4
Watlington	Glebe Farm, 500 yds after Cuxham Road	0703	1740	4
Cuxham	Bus stop nr Manor Farm	0706	1737	4
Chalgrove	Bus stop in Monument Road	0710	1733	4
Chalgrove	Bus stop by The Crown PH, High Street	0711	1732	4
Chalgrove	Bus stop by The Lamb PH, High Street / Mill Street	0713	1730	4
Stadhampton	The Green, opp. bench before roundabout	0716	1727	4
Little Milton	By the church	0719	1724	3
Little Milton	Village Hall	0720	1723	3
Great Milton	The Bull PH, The Green	0724	1716	3
Great Milton	Bus stop, Lower End	0725	1715	3
Wheatley	Bus stop, London Road nr Ambrose Rise	0733	1708	1
Wheatley	Bus stop, Bryant's Garage, Church Road	0735	1705	1
Sandhills	Bus stop on A40 just after Park & Ride	0740	1659	1
Pupils can also board at the following stops (or interim stops if timings allow) for cross-city travel e.g. from Summertown to Headington schools:				
Headington School	Headington Road / Headley Way	0755	1645	
Rye St. Antony	Franklin Road	0756	1646	
Magdalen College School	The Plain roundabout, opp. Sainsbury's (AM) / outside Sainsbury's (PM)	0803	1635	
d'Overbroeck's (Years 7-11)	Banbury Road nr Park Town	0821	1627	
Oxford High School (Junior School)	Bardwell Road	0822	1626	
Oxford High School (Senior School)	Charlbury Road	0825	1625	
d'Overbroeck's (Sixth Form Centre)	Banbury Road (nr Squitchey Lane)	0835	1620	

Route 6 - Wallingford

STOP	DESCRIPTION	AM	PM	ZONE
Goring	(Subject to demand)			5
Wallingford	Market Square	0710	1739	4
Crowmarsh Gifford	Benson Lane, by Howberry Farm	0713	1734	4
Benson	Bus stop	0716	1732	4
Shillingford	First bus stop	0720	1730	4
Berinsfield	Bikers cafe on A4074	0725	1725	3
Nuneham Courtenay	First bus stop	0730	1720	3
Sandford	Four Pillars Hotel	0735	1710	1
Pupils can also board at the following stops (or interim stops if timings allow) for cross-city travel e.g. from Summertown to Headington schools:				
Magdalen College School	Iffley Road outside the school	0755	1650	
Headington School	Headington Road	0805	1645	
Rye St. Antony	Franklin Road	0807	1643	

d'Overbroeck's (Sixth Form Centre)	Banbury Road nr Lathbury Road	0820	1630	
Oxford High School (Senior School)	Charlbury Road	0822	1628	
Oxford High School (Junior School)	Bardwell Road	0824	1626	
d'Overbroeck's (Years 7-11)	Banbury Road nr Park Town	0826	1624	

Route 7 - Sutton Courtenay

STOP	DESCRIPTION	AM	PM	ZONE
Sutton Courtenay	Brook Street	0655	1743	4
Drayton	Post Office	0700	1738	4
Abingdon	Beefeater on Marcham Road	0712	1728	3
Boars Hill	Opp. Foxcombe Hall, Berkley Road	0723	1718	1
Hinksey Hill	Bus stop, Foxcombe Road, Hinksey Hill	0727	1714	1
Pupils can also board at the following stops (or interim stops if timings allow) for cross-city travel e.g. from Summertown to Headington schools:				
Magdalen College School	Iffley Road outside the school	0750	1650	
Headington School	Headington Road	0800	1645	
Rye St. Antony	Franklin Road	0802	1643	
d'Overbroeck's (Sixth Form Centre)	Banbury Road nr Lathbury Road	0815	1630	
Oxford High School (Senior School)	Charlbury Road	0817	1628	
Oxford High School (Junior School)	Bardwell Road	0819	1626	
d'Overbroeck's (Years 7-11)	Banbury Road nr Park Town	0822	1624	

Route 8 - Stanford in the Vale

STOP	DESCRIPTION	AM	PM	ZONE
Stanford in the Vale	Church Green bus stop	0650	1738	4
Buckland	The Lamb PH	0700	1725	4
Hinton Waldrist	High Street bus stop	0706	1719	4
Kingston Bagquize	Business Park bus stop	0710	1715	4
Frilford	Petrol Station	0715	1711	4
Marcham	Marcham Post Office	0717	1708	3
Wootton	Matthews Way bus stop	0724	1701	3
Cumnor	Vine Inn Car Park on Glebe Road	0727	1658	2
Osney	Bus stop	0737	1648	1
Pupils can also board at the following stops (or interim stops if timings allow) for cross-city travel e.g. from Summertown to Headington schools:				
d'Overbroeck's (Years 7-11)	Banbury Road nr Park Town	0750	1636	
Oxford High School (Junior School)	Bardwell Road	0752	1634	
Oxford High School (Senior School)	Charlbury Road	0755	1632	
d'Overbroeck's (Sixth Form Centre)	Banbury Road nr Lathbury Road	0757	1630	
Rye St. Antony	Franklin Road	0810	1617	
Headington School	Headington Road	0812	1615	
Magdalen College School	The Plain roundabout, opp. Sainsbury's (AM) / outside Sainsbury's (PM)	0820	1610	

● Route 9 - Bourton-on-the-Water

STOP	DESCRIPTION	AM	PM	ZONE
Bourton-on-the-Water	Bourton Business Park	0620	1805	5
Stow-on-the-Wold	Sheep Street by Porch House	0630	1755	5
Chipping Norton	Opp. Town Hall	0655	1735	4
Chapel House Garage	Wheelers (jct A44/A3400/A361)	0700	1730	4
Enstone	Opp. Enstone Green (Adams stores)	0710	1720	4
A44 Wooton Turn	Judd's Garage	0720	1715	3
Woodstock	Opposite Blenheim Main Gates	0725	1705	2
Yarnton	A44 Roundabout (bus stop before Sandy Lane)	0730	1700	2
Cotteslowe	Bus stop by cemetery	0745	1645	1
Pupils can also board at the following stops (or interim stops if timings allow) for cross-city travel e.g. from Summertown to Headington schools:				
d'Overbroeck's (Sixth Form Centre)	Banbury Road nr Squitchey Lane	0755	1635	
Oxford High School (Senior School)	Charlbury Road	0803	1630	
Oxford High School (Junior School)	Bardwell Road	0806	1625	
d'Overbroeck's (Years 7-11)	Banbury Road nr Park Town	0808	1623	
Magdalen College School	The Plain roundabout, opp. Sainsbury's (AM) / outside Sainsbury's (PM)	0818	1615	
Headington School	Headington Road	0823	1610	
Rye St. Antony	Franklin Road	0828	1605	

OSBP fare zones, September 2017

Pupils must pay for travel Monday to Friday but can choose to travel AM or PM only. Cross-Oxford trips (subject to seat availability): £495 p.a.

	Cost per year for return trip (£)	Cost per term for return trip (£)	Cost per trip (assuming pupil travels for 170 school days) (£)	AM or PM only (70% of return ticket price)
Zone 1	705	235	4.15	490
Zone 2	1245	415	7.32	870
Zone 3	1335	445	7.85	935
Zone 4	1440	480	8.47	1010
Zone 5	1650	550	9.71	1155
Cross-Oxford	495	165	2.91	347

POLICIES AND ADDITIONAL INFORMATION

The following policies and information are available in the aims and policies section of the website for both prospective and current parents, and are also available for inspection in school free of charge:

- A statement and a summary of the school's aims
- The admissions policy
- The safeguarding policy
- The Magdalen College Choir child safeguarding policy
- The anti-bullying policy
- The curriculum policy
- The discipline and exclusion policy
- The promoting good behaviour policy
- The complaints procedure
- Details of how to contact the Chairman of Governors

The following information is available on the school's website at <http://www.mcsoxford.org/senior-school/results-reports-and-destinations>

- The latest ISI inspection report
- The school's academic performance last school year

The following additional policies are available on request or may be consulted in school free of charge:

- The learning support policy, including reference to the education and welfare provision for pupils with EHC plans and pupils for whom English is an additional language
- The school's health and safety policy
- The policy for health and safety on school visits
- The first aid policy
- The missing pupil policy
- A record of formal complaints last school year



SCHOOL FEES AND CHARGES 2017-2018

Tuition fees, which are kept as low as possible, are reviewed annually by the School Governors when they set the school budget, and are announced in May each year. Extras are deliberately avoided as much as possible.

Senior School

£

The fees for the academic year 2017/18 are: 5,928.00 per term (17,784.00 per annum)

Optional Charges and Insurances

Old Waynfletes' (OWs) Club	150.00	(a one-off payment)
Parents' Association (PA)	5.00	per term
Music Lessons	318.00	per term for 10 lessons
Combined Cadet Force (CCF) from U4th	60.00	per annum

LAMDA Lessons

	30 Mins	45 Mins	60 Mins
Solo	27.00	40.00	52.00
Duo	13.50	20.50	28.00
Group	8.50	13.00	16.50

Catering

Breakfast		charged per item
Morning Break Meal	4.50	per day
Tuck Shop		charged per item
Lunch	4.50	per day

Pupils will register for meals via our biometric register and charges will be made in arrears.

Junior School

£

The fees for the academic year 2017/18 are:

J1 – J2	5,710.00 per term (17,130.00 per annum)
J3 – J4	5,928.00 per term (17,784.00 per annum)

Optional Charges and Insurances

Old Waynfletes' (OWs) Club	150.00	(a one off payment)
Parents' Association (PA)	5.00	per term
Music Lessons	318.00	per term for 10 lessons

LAMDA Lessons

	30 Mins
Solo	27.00
Duo	13.50
Group	8.50

Catering

Breakfast		charged per item
Lunch	2.30	per day

Lunch for all boys in the Junior School is compulsory. Parents who would like their son to opt out of lunch are required to confirm this in writing to the Head of the Junior School.

NEW SIXTH FORM CENTRE

BUILDING FOR THE FUTURE

The exciting first phase of the MCS Development Plan will see a purpose-built Sixth Form Centre erected between the New Building and Colin Sanders Building.

The building, due to be completed during Michaelmas 2017, will incorporate key design features to provide a stylish and contemporary social and study complex, sensitively integrated into the school environment.

With an overall floor area of 1,650m², the new Centre will add significantly to the Sixth Form experience for students, at one of the most formative times in their lives. Social space will be the key feature of the four-storey building, which will also include cafeteria, study space and offices.

You can find our more information about the new Centre via the Sixth Form pages of the website, including a document outlining the effects of the building work and answers to some Frequently Asked Questions.

SIXTH FORM CENTRE - NEARING COMPLETION!



ARTIST'S IMPRESSIONS OF INTERIOR





MAGDALEN COLLEGE SCHOOL

INDEPENDENT DAY SCHOOL FOR BOYS 7 - 18 AND SIXTH FORM GIRLS

CONTACT INFORMATION

Registrar, Mrs Barberine Mallett:

registrar@mcsoxford.org 01865 253430

Assistant Registrar, Ms Emma Bolton:

ebolton@mcsoxford.org

Assistant Registrar, Mrs Claire Townsend:

ctownsend@mcsoxford.org

Bursar, Mr Tim Knowles:

bursar@mcsoxford.org

Reception:

enquiries@mcsoxford.org 01865 242191

WEBLINKS

Admissions Information:

www.mcsoxford.org/admissions

To book an Open Afternoon:

www.mcsoxford.org/opendays

Scholarships and Bursaries:

www.mcsoxford.org/scholarships

Aims, Policies and Plans:

www.mcsoxford.org/our-communities/aims-policies-and-plans